

**TOP VIEW**

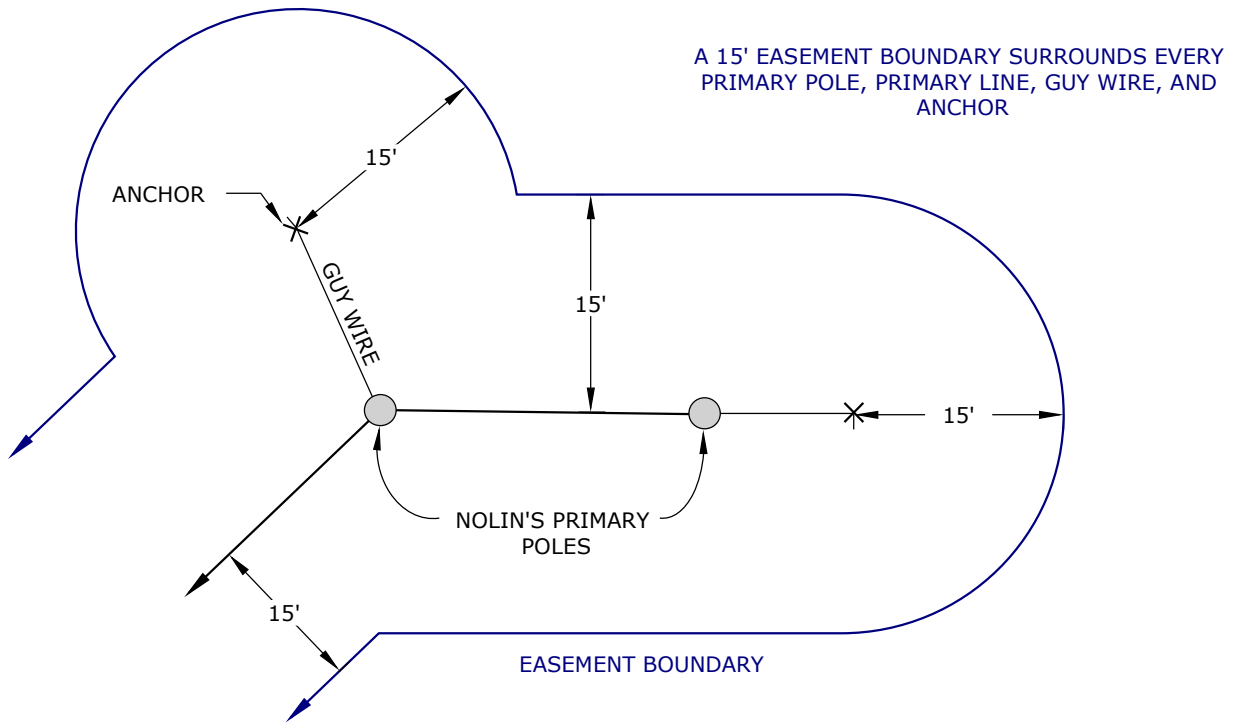

- DIAGRAM NOT TO SCALE
- CONTACT NOLIN RECC LINE DESIGN DEPARTMENT BEFORE STARTING ANY WORK
- CALL 811 BEFORE DIGGING

<b>NOTES</b>	
No structures may be installed within these easements. This includes houses, sheds, garages, billboards, signs, flagpoles, consumer owned electric poles, etc. No objects are to be attached to Nolin's poles. This includes signs, security cameras, bird houses, etc.	



A Touchstone Energy® Cooperative

MAIN OFFICE: 270-765-6153

DRAWN BY:  
LANDER RYAN

APPROVED BY:  
GREG LEE

**PRIMARY OVERHEAD  
EASEMENTS**

LAST REVISION

5/30/2018